

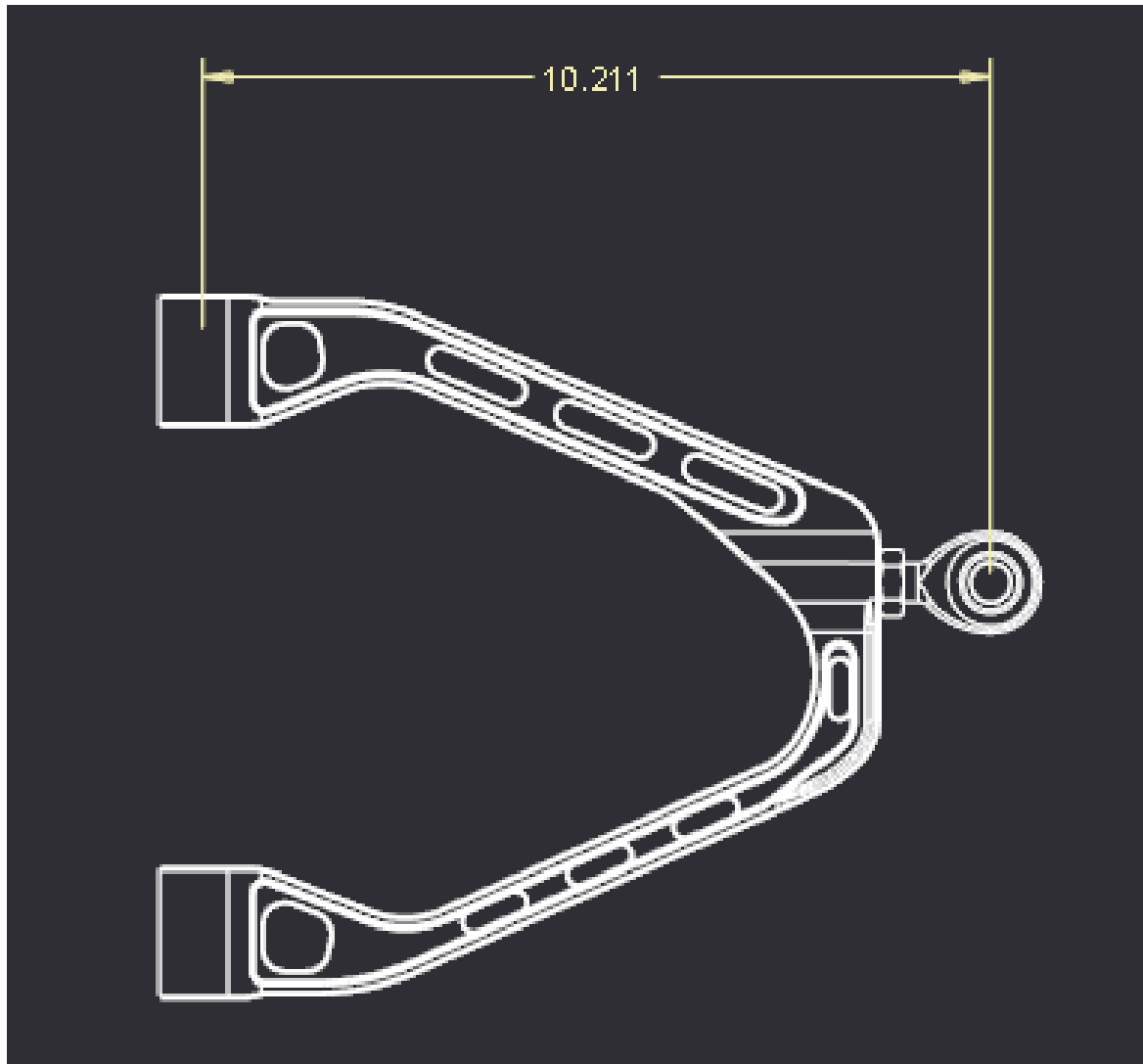

Polaris 37" Adjustable Upper A-Arm

- Note: These a-arms have adjustable camber. Changing this setting from stock can cause dangerous handling characteristics. Only change this setting if you are knowledgeable with suspension tuning.
- Install a-arm on to the snowmobile in place of the stock upper a-arm.
- Make sure to reuse all stock washers.
- Torque 12-point bolt, on top of the heim joint. to 30 Ft-Lbs. Use blue Loctie.
- Loosen jam nut. Compress front suspension a few times. The Heim will find a home at a slight angle. Tighten jam nut with the heim in this orientation.



Please email zrp.engineering@gmail.com if there is any issue with your order. We will work tirelessly to make it right!

Like us on fb.me/ZollingerRacingProducts & Order at: ZOLLINGERRACINGPRODUCTS.COM

Remember: Performance Matters!